

# B260.6.

Код / Code	Конус	$dm_t$	$D_1$	$D_{21}$	$D_{22}$	$L_{C1}$	$L_{C2}$	$L_1$	$L_3$	$L_{21}$	$L_{22}$	$L_{23}$	$L_{24}$	Модель
B260.6.40.95.06S	40	6	40	12		40	30	95	50			68		1
B260.6.40.95.08S	40	8	40	14,5		40	30	95	50			68		1
B260.6.40.95.10S	40	10	40	17		40	37	95	50			68		3
B260.6.40.145.10S	40	10	40	17		40	37	145	100			118		3
B260.6.40.95.12S	40	12	40	19,5		40	37	95	50			68		
B260.6.40.145.12S	40	12	40	19,5		40	37	145	100			118		1
B260.6.40.195.12S	40	12	40	19,5	24,5	40	37	195	150	50	75	168		1
B260.6.40.120.16S	40	16	40	26		50	47	120	75			93		1
B260.6.40.170.16S	40	16	40	26		50	47	170	125			143		2
B260.6.40.155.20S	40	20	40	32		52	49	155	110			128	60	3
B260.6.40.235.20S	40	20	40	32		52	49	235	190			208	60	3
B260.6.50.106.12S	50	12	40	19,5		40	37	106	50			68		1
B260.6.50.156.12S	50	12	40	19,5		40	37	156	100			118		1
B260.6.50.206.12S	50	12	40	19,5	24,5	40	37	206	150	50	75	168		2
B260.6.50.166.20S	50	20	40	32		52	49	166	110			128	60	3
B260.6.50.246.20S	50	20	40	32		52	49	246	190			206,5	60	3

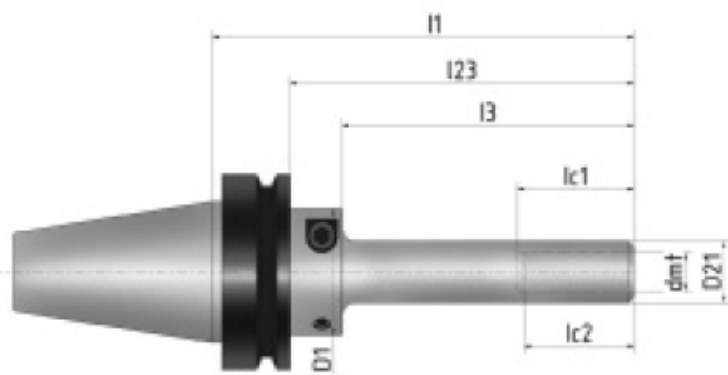

ISO форма модель 1  
ISO form design 1

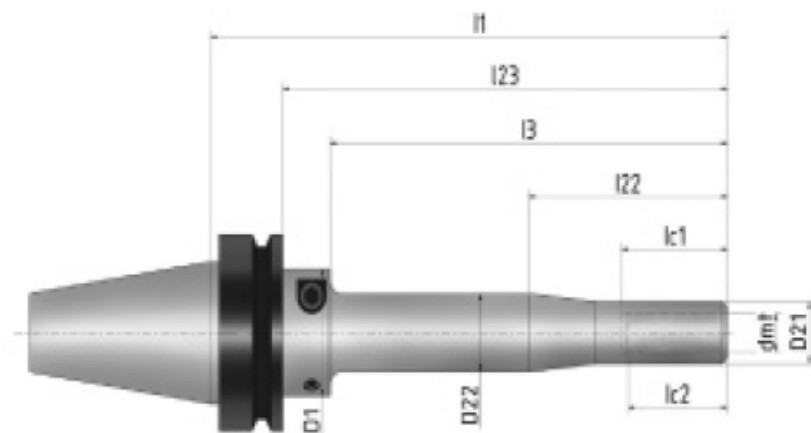

ISO форма модель 2  
ISO form design 2

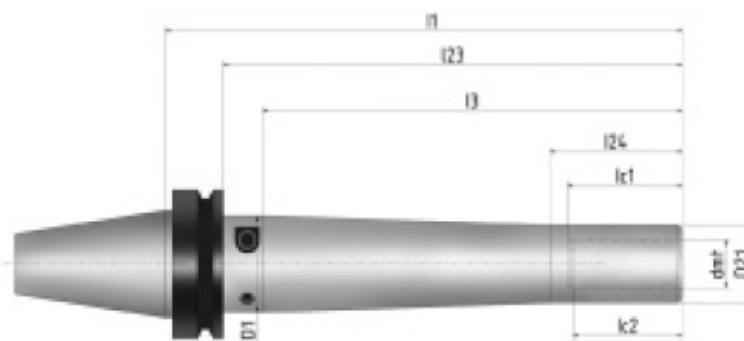

ISO форма модель 3  
ISO form design 3

l1 = программируемая длина  
l1 = programming length